

VISIBLE LIGHT PRODUCTS

(Super Blue Light Emitting Diode)

REV:A
DATE:2001/10/16

ESD Products! Class I

DEVICE NO:HB3b-448ABCA

LENS COLOR:

colored diffusion	colored transparent	white diffusion	✓	water clear
-------------------	---------------------	-----------------	---	-------------

PACKAGE DIMENSIONS:

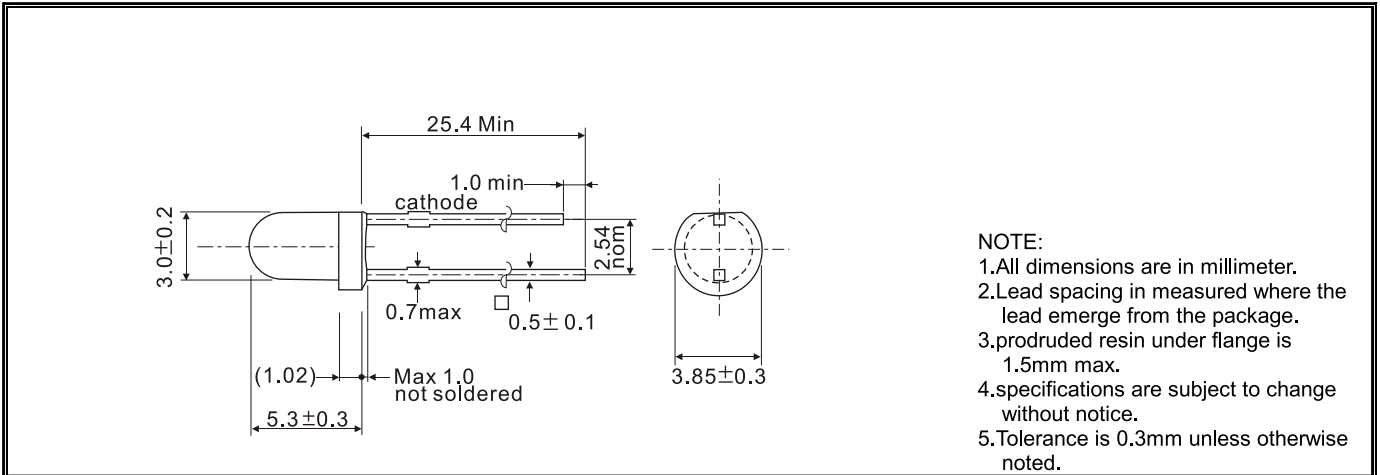

ABSOLUTE MAXIMUM RATINGS:

Material: InGaN/GaN

TA=25°C

PARAMETER	SYMBOL	MAX. RATING	UNIT
Power Dissipation	Pd	120	mW
Continuous Forward Current	IF	30	mA
Peak Forward Current *1	IFM	100	mA
Reverse Voltage	VR	5	V
Operating Temperature	Topr	-25 ~ +85	°C
Storage Temperature	Tstg	-40 ~ +100	°C
Lead Soldering Temperature (1.6mm from case Bottom 240 °C for 5 seconds)			

ELECTRIC-OPTICAL CHARACTERISTICS:

TA=25°C

PARAMETER	SYMBOL	TEST CONDITION	MIN	TYP	MAX	UNIT
View Angle of Half Power	2θ1/2	IF=20mA		15		Degree
Forward Voltage	VF	IF=20mA		3.5	4.0	V
Reverse Current	IR	VR=4V			60	uA
Luminous Intensity *2	IV	IF=20mA	1200	2700		mcd
Peak Emission Wavelength	λp	IF=20mA		468		nm
Dominate Wave Length *3	λd(HUE)	IF=20mA	465	471	475	nm
Spectrum Width of Half Valve	Δλ	IF=20mA		35		nm
Optic Rise Time	τ	IF=20mA		30		ns

*1. Duty Ratio=1/10, Pulse Width=0.1ms.

*2. Tolerance: 30% measuring equipment : 1. EXELTRON 2001. 2. S370 made by U.D.T.

*3. The dominate wavelength is derived from the CIE Chromaticity Diagram and represents the color of the device.