

# LOW PROFILE SURFACE MOUNT COIN CELL HOLDERS

AVAILABLE ON TAPE AND REEL

- Surface mount coin cell holders designed for reflow or wave soldering.
- Battery can be installed and replaced with ease.

- Solder tails are viewable for quick inspection of the solder joint.
- All holders are available on tape and reel for pick and place applications.

- All conductive polystyrene carrier tape meets ANSI/EIA - 481 standard.

## 1/3N CELL

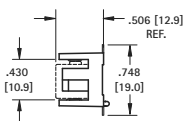
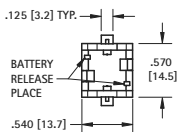

### Pad Layout

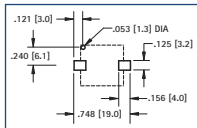

### MATERIAL:

**Contacts:** .012 (.30) Phosphor Bronze, Gold Plate (Flash)  
**Base:** High Temperature Nylon 46, UL94V-0

**CAT. NO. 498** (Bulk)

**CAT. NO. 498TR** (Tape & Reel)

**Tape & Reel Spec's:** 44mm wide; 24mm pitch; 13 inch reel (150 pieces per reel)

## TOP LOADING

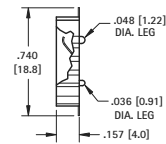
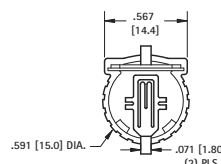

### Pad Layout

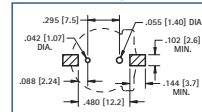

### MATERIAL:

**Contacts:** .008 (.20) Phosphor Bronze, Gold Plate (Flash)  
**Base:** Glass filled PPS, UL 94V-0

**CAT. NO. 1056** (Bulk)

**CAT. NO. 1056TR** (Tape & Reel)

**Tape & Reel Spec's:** 32mm wide; 20mm pitch; 13 inch reel (500 pieces per reel)

## 2025 / 2032 CELL

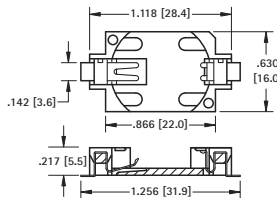

### Pad Layout

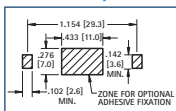

### MATERIAL:

**Contacts:** .006 (.15) Phosphor Bronze, Gold Plate (Flash)  
**Base:** Glass Filled LCP, UL 94V-0

**CAT. NO. 1060** (Bulk)

**CAT. NO. 1060TR** (Tape & Reel)

**Tape & Reel Spec's:** 44mm wide; 24mm pitch; 13 inch reel (500 pieces per reel)

## 2450 CELL

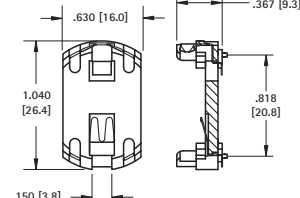

### Pad Layout

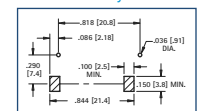

### MATERIAL:

**Contacts:** .008 (.20) Phosphor Bronze, Gold Plate (Flash)  
**Base:** High Temperature Nylon 46, UL94V-0

**CAT. NO. 1054** (Bulk)

**CAT. NO. 1054TR** (Tape & Reel)

**Tape & Reel Spec's:** 44mm wide; 24mm pitch; 13 inch reel (200 pieces per reel)

## SIDE LOADING

### 20mm & 23mm CELLS

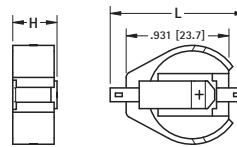
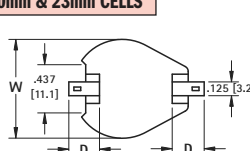

### Pad Layout

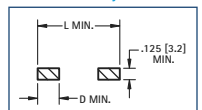

**MATERIAL:** **Contacts:** .015 (.38) Steel **Base:** High Temperature, Nylon 46, UL 94V-0  
**Tape & Reel Spec's:** 44mm wide; 32mm pitch; 13 inch reel (200 pieces per reel)

### SMALL PAD PATTERN

**Contacts:** Tin Nickel-Plate

CAT. NO. BULK	CAT. NO. TAPE	CELLS	H	W	L	D	CELL	BATTERY
1061	1061TR	1	.290 (7.4)	.896 (22.8)	1.015 (25.8)	.156 (4.0)	20mm	2016*, 2020, 2025, 2032
1062	1062TR	2	.391 (9.9)	.896 (22.8)	1.015 (25.8)	.156 (4.0)	20mm	2016*, 2020, 2025, 2032
1071	1071TR	1	.290 (7.4)	1.000 (25.4)	1.015 (25.8)	.156 (4.0)	23mm	2320, 2325, 2330

\*Cat. No. 1061 (1 or 2 cells); Cat. No. 1062 (3 cells)

### Contacts: Gold Plate (Flash)

CAT. NO. BULK	CAT. NO. TAPE	CELLS	H	W	L	D	CELL	BATTERY
1081	1081TR	1	.290 (7.4)	.896 (22.8)	1.015 (25.8)	.156 (4.0)	20mm	2016*, 2020, 2025, 2032
1082	1082TR	2	.391 (9.9)	.896 (22.8)	1.015 (25.8)	.156 (4.0)	20mm	2016*, 2020, 2025, 2032
1091	1091TR	1	.290 (7.4)	1.000 (25.4)	1.015 (25.8)	.156 (4.0)	23mm	2320, 2325, 2330

\*Cat. No. 1081 (1 or 2 cells); Cat. No. 1082 (3 cells)

### LARGE PAD PATTERN

**Contacts:** Tin-Nickel Plate

CAT. NO. BULK	CAT. NO. TAPE	CELLS	H	W	L	D	CELL	BATTERY
1063	1063TR	1	.290 (7.4)	.896 (22.8)	1.250 (31.8)	.278 (7.1)	20mm	2016*, 2020, 2025, 2032
1064	1064TR	2	.391 (9.9)	.896 (22.8)	1.250 (31.8)	.278 (7.1)	20mm	2016*, 2020, 2025, 2032
1073	1073TR	1	.290 (7.4)	1.000 (25.4)	1.250 (31.8)	.278 (7.1)	23mm	2320, 2325, 2330

\*Cat. No. 1063 (1 or 2 cells); Cat. No. 1064 (3 cells)

### Contacts: Gold Plate (Flash)

CAT. NO. BULK	CAT. NO. TAPE	CELLS	H	W	L	D	CELL	BATTERY
1093	1093TR	1	.290 (7.4)	.896 (22.8)	1.250 (31.8)	.278 (7.1)	20mm	2016*, 2020, 2025, 2032
1094	1094TR	2	.391 (9.9)	.896 (22.8)	1.250 (31.8)	.278 (7.1)	20mm	2016*, 2020, 2025, 2032
1083	1083TR	1	.290 (7.4)	1.000 (25.4)	1.250 (31.8)	.278 (7.1)	23mm	2320, 2325, 2330

\*Cat. No. 1093 (1 or 2 cells); Cat. No. 1094 (3 cells)

## INSULATED RETAINERS

### 20mm CELLS



- Ideal for 6 volt or 3 volt applications.
- Two coin cell batteries can be installed in series.
- Plastic insulator prevents shorting of battery, within the holder, if installed improperly.
- Low profile.
- Battery release ports for easy battery replacement.

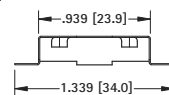
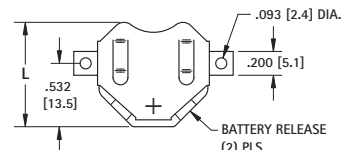

### Pad Layout

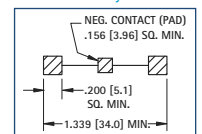

**MATERIAL:** **Contacts:** .010 (.25) Phosphor Bronze  
**Insulator:** High Temperature, Nylon 46, UL 94V-0  
**Tape & Reel Spec's:** 44mm wide; 28mm pitch; 13 inch reel  
**3020TR, 3070TR** 500 pieces per reel  
**3022TR, 3072TR** 250 pieces per reel

TIN-NICKEL PLATE		MATTE TIN PLATE		BATTERY REFERENCE			
CAT. NO. BULK	CAT. NO. TAPE	CAT. NO. BULK	CAT. NO. TAPE	L	H	6 volt (2) Cells	3 volt (1) Cell
3020	3020TR	3070	3070TR	.890(22.6)	.156(4.0)	2012, 2016	2020, 2025
3022	3022TR	3072	3072TR	.877(22.3)	.240(6.1)	2020, 2025	2032